

1: INSTALL ENTRY LOCKSET AND DEAD BOLT IN DOOR

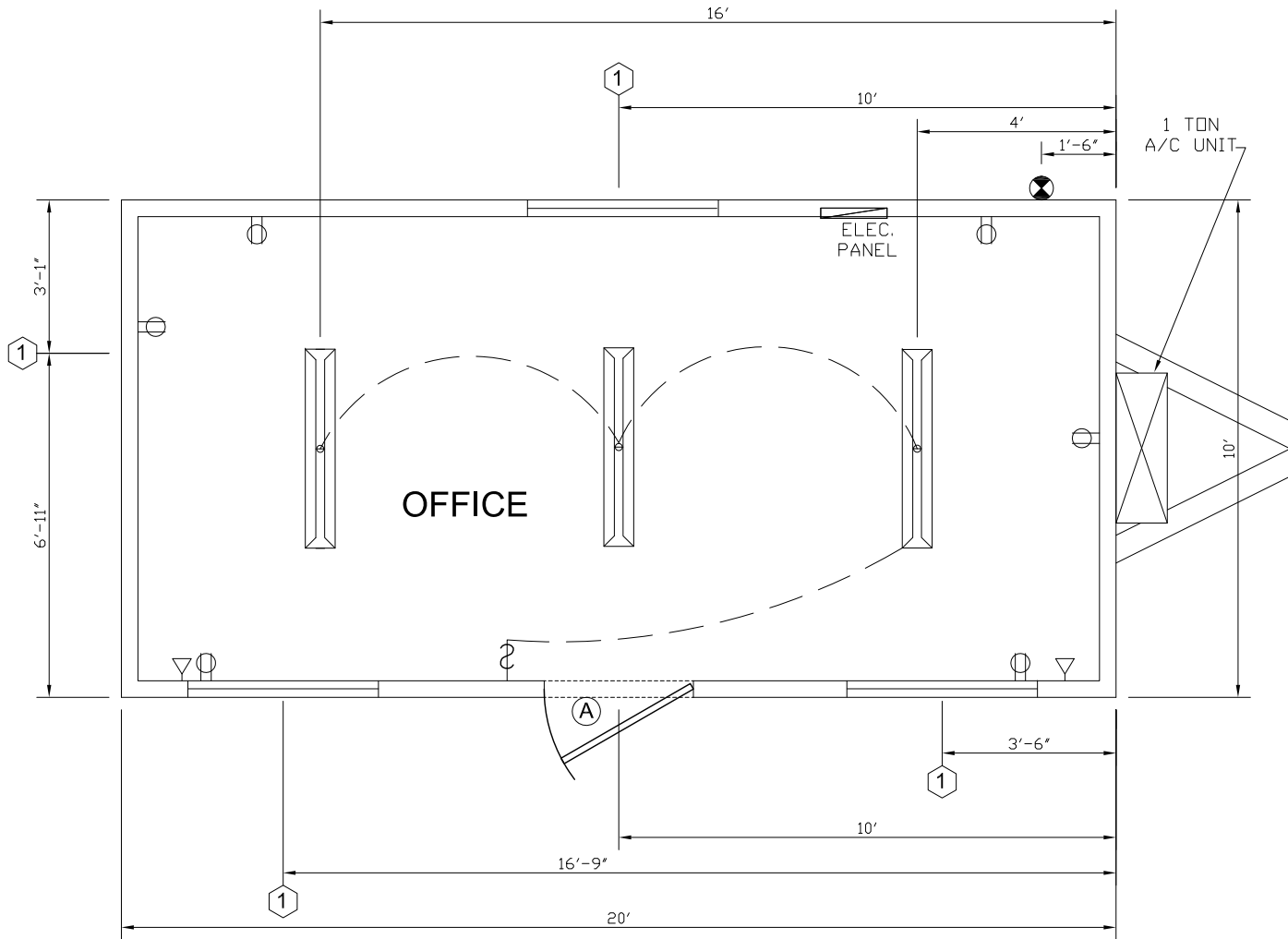





FLOOR PLAN

DOOR SCHEDULE			
MARK	SIZE	DISCRIPTION	HARDWARE
A	36 x 80	TELL STEEL	SEE NOTE #1

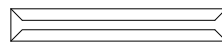
WINDOW SCHEDULE		
MARK	SIZE	DISCRIPTION
1	46 x 27	H/S (CLEAR) SINGLE STRENGTH

SYMBOL LEGEND FOR ELECTRICAL

-  = 64-WATT FLUORESCENT 2-TUBE, DIFFUSED LIGHT
-  = 110V DUPLEX RECEPTACLE
-  = 125 AMP BREAKER BOX
-  = INTERIOR LIGHTS SWITCHES
-  = PHONE "J" BOX

GENERAL SHELTERS OF TEXAS, INC.

TITLE:	FLOOR PLAN		
CUSTOMER:			
PROJECT:	10' x 20' MOBILE BUILDING	JOB NO.	042610
DATE:	4/26/10	SCALE:	NONE



FP

SHEET

10' x 20' MOBILE BUILDING

SPECIFICATIONS

BOX SIZE: 10' x 20'
TYPE: MOBILE BUILDING

FRAME:

TYPE: OUTRIGGER
BEAM: JR BEAM
HITCH: STANDARD
AXLES: SINGLE
TIRES: (2) 8-PLY

FLOOR:

BOTTOM BOARD: 30ga. STEEL
INSULATION: R11 KRAFT
JOISTS: 2x6 #3 SYP @ 16" O.C.
DECKING: 3/4" TONGUE & GROOVE PLYWOOD
COVERING: 1/8" TILE (COTTAGE TAN)
SKID: NONE

EXTERIOR WALLS:

STUDS: 2x4 STUD GRADE (SYP) @ 16" O.C. (8'-0" WALL HT.)
BOTTOM PLATE: 2x4 SINGLE BOTTOM PLATE
TOP PLATE: 2x4 DOUBLE TOP PLATE
COVERING: VINYL GYPSUM
SHEATING: NONE
INSULATION: R13 KRAFT
SIDING: 26 ga. PAINTED GALV. STEEL
TRIM: 26 ga. PAINTED GALV. STEEL

INTERIOR WALLS:

STUDS: NA
COVERING: NA
INSULATION: NA
CLOSETS: NA

ROOF:

RAFTERS: TAPERED 2 x 8 (24" O.C.) MONO-SLOPE
CEILING: SUSPENDED T-BAR
INSULATION: R-19 KRAFT FACED FIBERGLASS
SHEATING: 3/8" OSB PLYWOOD SHEATHING
ROOFING: 26 ga. PAINTED GALV. STEEL
TRIM: 26 ga. PAINTED GALV. STEEL
TIE DOWN: NONE

DOORS:

EXTERIOR DOORS: (1) 36" x 80" TEEL WHITE STEEL/STEEL
W/ ENTRY LOCKSET, DEADBOLT
INTERIOR DOORS: NONE

WINDOWS:

WINDOW 1: (3) 46x27 CLEAR GLAZE (SINGLE STRENGTH)

ELECTRICAL:

LOAD PANEL: (1) 125-AMP W/ MAIN
RACEWAY: ROMEX (#14 WIRE MINIMUM)
LIGHTS: (3) FLUORESCENT (2) BULB 4' DIFUSSED

RECEPTACLES: (6) 110-VOLT 15-AMP DUPLEX
MISCELLANEOUS: (2) EMPTY "J" BOX
RUNNING LIGHTS

PLUMBING:

WATER CLOSETS: NONE
MODESTY PARTITION: NONE
URINAL: NONE
LAVATORY: NONE
WATER HEATER: NONE
SHOWER: NONE
POTABLE WATER: NONE
DWV: N/A
SEWER VENT: N/A
ACCESSORIES: NONE
MISCELLANEOUS: N/A

HVAC:

A/C - HEATING: (1) 1 TON A/C UNIT
DUCT: FIBERGLASS
DIFFUSERS: (3) 24 x 24 (4 WAY)
RETURNS: AT UNIT
EXHAUST FANS: NONE

MISC:

DESK: NONE
PLAN TABLE: NONE

GENERAL SHELTERS OF TEXAS, INC.



TITLE:	SPECIFICATIONS	
CUSTOMER:		
PROJECT:	10' x 20' MOBILE BUILDING	JOB NO.
		042610

SHEET

SS

DATE: 4/26/10

SCALE: NONE