

NOTES:

- 1 INSTALL STATE SEAL AND DATA PLATE 12" A.F.F. IN LOCATION SHOWN.
- 2 (2) 2x4 COLUMN W/ SIMPSON 1 1/2" WIDE 18 GA. STRAP W/ (6) 10d NAILS TOP AND BOTTOM WHERE SHOWN.
- 3: INSTALL LEVER ENTRY LOCKSET, DEAD BOLT (KEYED EXTERIOR/THUMBTURH INTERIOR), 10"x 10" WINDOWS (SAFTY GLASS) IN DOOR AND CLOERS

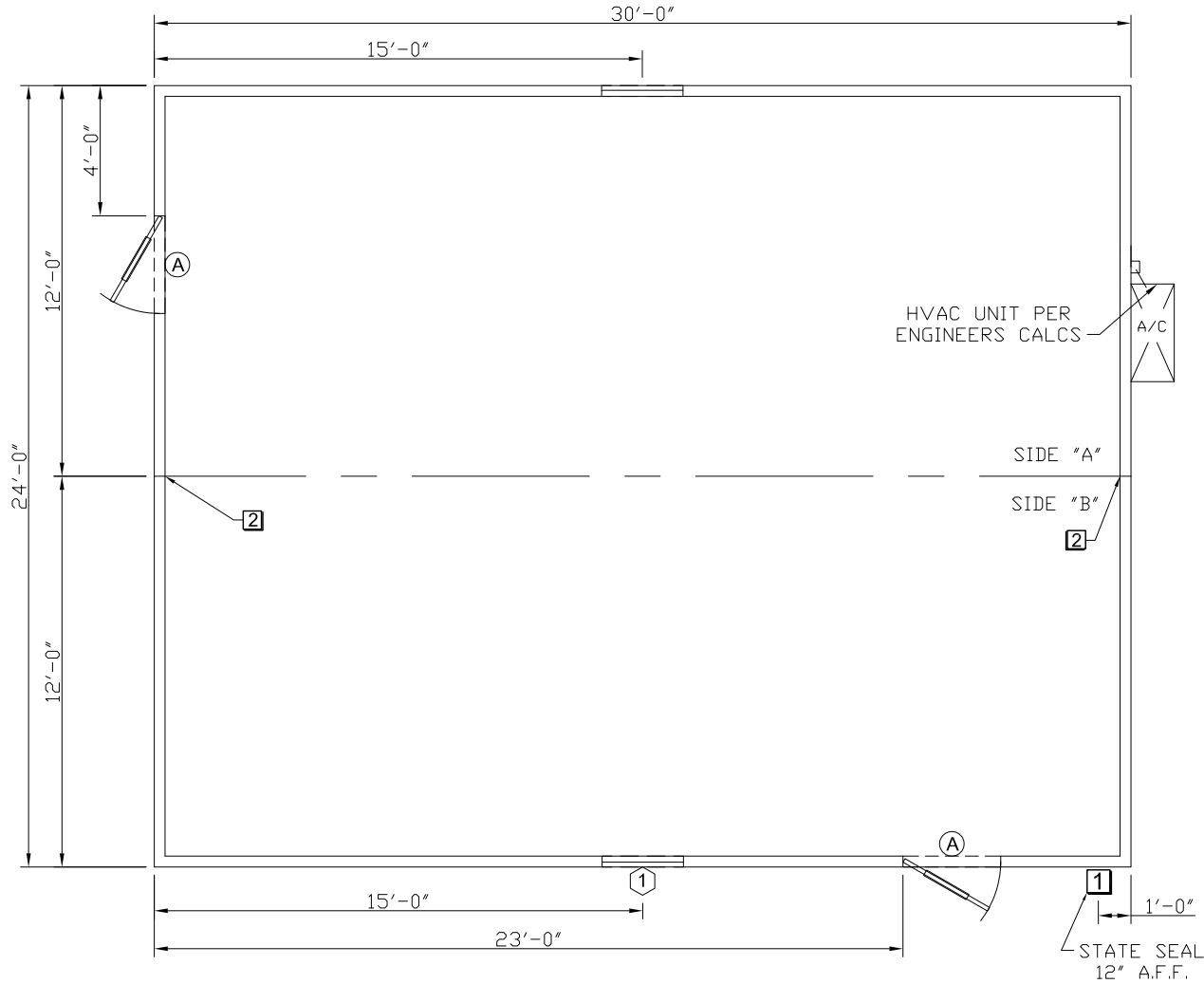

FLOOR PLAN

DOOR SCHEDULE			
MARK	SIZE	DISCRIPTION	HARDWARE
A	36 x 80	MD-300	SEE NOTE 3

WINDOW SCHEDULE		
MARK	SIZE	DISCRIPTION
1	30 x 42	CLEAR INSULATED GLASS LOW "E"

GENERAL SHELTERS OF TEXAS, INC.

<p>Serving The Southwest "Exclusively Through Independent Dealers"</p>	TITLE:	FLOOR PLAN
	CUSTOMER:	
PROJECT:	24 x 30 CLASSROOM	JOB NO. 070407
SHEET	FP	DATE: 7/16/07
		SCALE: NONE

NOTES:
 1. INTERNAL DISCONNECT WITH EXTERNAL ACCESS PROVIDED.

WHEN WIRING IN EMT THE FOLLOWING CONDITIONS MUST BE MET:
 1. PULL GREEN (NOT BARE) GROUND WIRE FOR EACH BRANCH CIRCUIT.
 2. SWITCHES AND RECEPTACLES MUST BE GROUNDED TO JUNCTIONS USING A #12 GREEN PIGTAIL.
 3. CONNECTIONS ENTERING JUNCTION BOXES MUST HAVE A BUSHING INSTALLED.
 4. NUMBER OF CONDUCTORS ALLOWED IN A BOX SHALL COMPLY WITH 370-16(a) OF THE NEC.

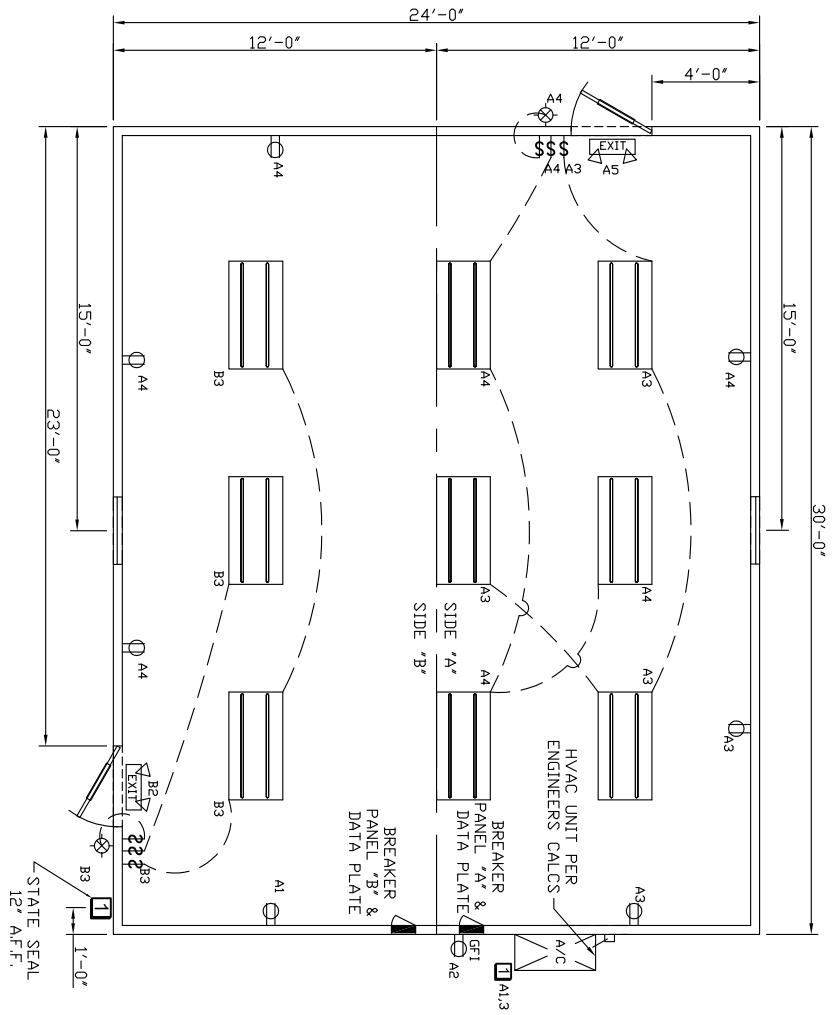

125 AMP - 120/240V 1 PHASE SERVICE PANEL 'A'		THHN WIRE GAUGE SIZES		125 AMP - 120/240V 1 PHASE SERVICE PANEL 'B'		THHN WIRE GAUGE SIZES	
#1-60A		#1	#12	#1-15A		#1	#12
#2-15A		#2	#12	#2-15A		#2	#12
#3-15A		#3	#12	#3-15A		#3	#12
#4-15A		#4	#12	#4-15A		#4	#12
#5-15A		#5	#12			#5	#12
SPARE		#6	#12			#6	#12
SPARE		#7	#12			#7	#12
SPARE		#8	#12			#8	#12
SPARE		#9	#12			#9	#12
SPARE		#10	#12			#10	#12
SPARE		#11	#12			#11	#12
SPARE		#12	#12			#12	#12

SYMBOL LEGEND FOR ELECTRICAL

= 64-WATT FLUORESCENT 2-BULB
2 X 4 DROP-IN DIFFUSED

= 27-WATT INCANDESCENT COMB. EMERGENCY/EXIT LIGHT

= GLOBE PORCH LIGHT (PHOTOCELL)

= 180-WATT DUPLEX RECEPTACLE
 = 180-WATT DUPLEX GFI RECEPTACLE
 = BREAKER BOX

NOTE:
 SIZING OF SERVICE CONDUCTORS AND GROUNDING
 CONDUCTOR TO BE DETERMINED END USER
 PER THE LATEST ADDITION OF THE N.E.C.

GENERAL SHELTERS OF TEXAS, INC.



TITLE: ELECTRICAL PLAN	
CUSTOMER:	
PROJECT: 24 x 30 CLASSROOM	JOB NO. 070407

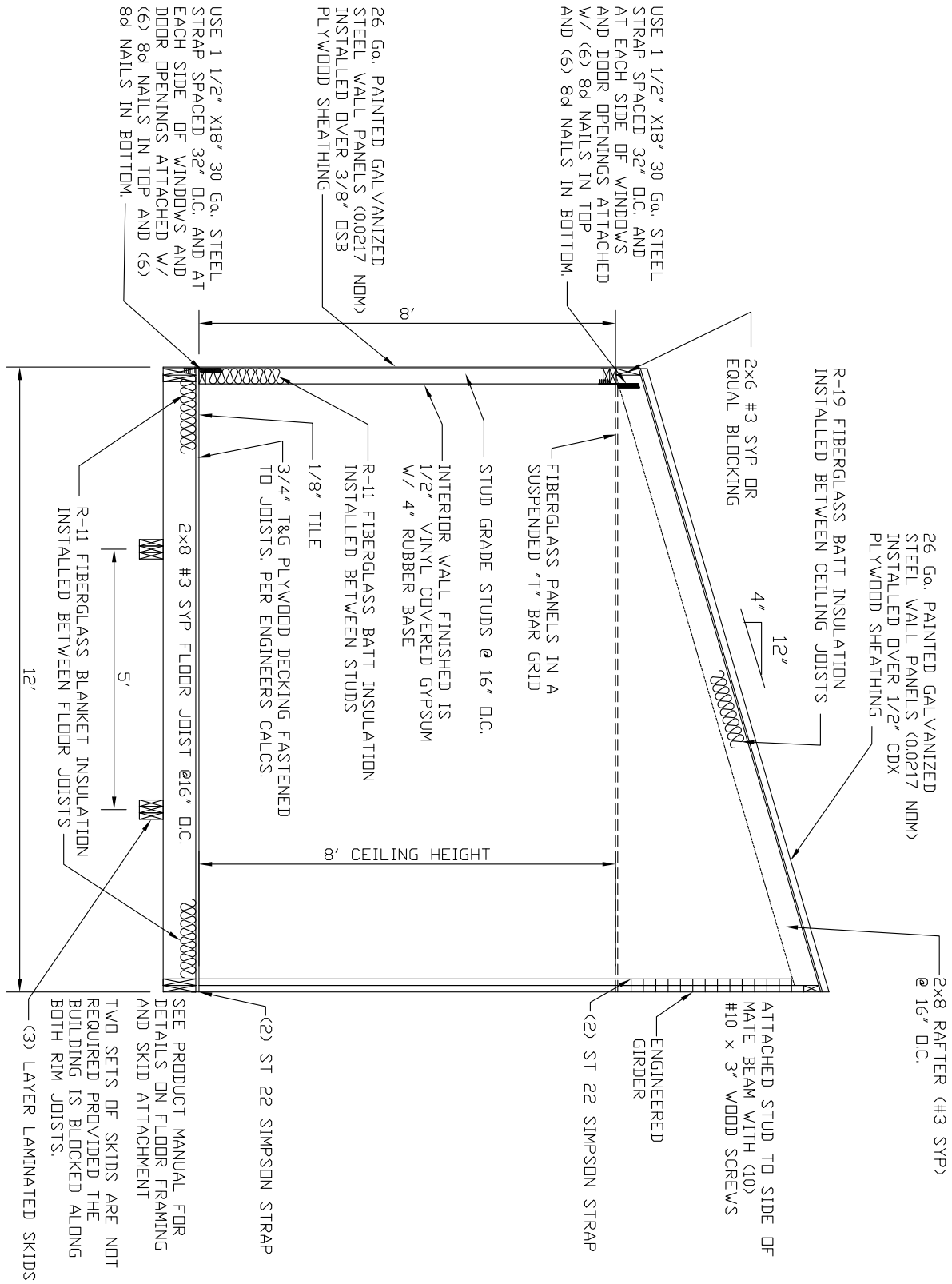

GENERAL SHELTERS OF TEXAS, INC.



Serving The Southwest
"Exclusively Through Independent Dealers"

TITLE: CROSS SECTION DETAIL

CUSTOMER:

PROJECT: 24 x 30 CLASSROOM

JOB NO. 070407

SHEET **CS**

DATE: 7/16/07

SCALE: NONE

24' x 30' CISD CLASSROOM

SPECIFICATIONS

BOX SIZE: 24' x 30'
TYPE: GABLE

FLOOR:

BOTTOM BOARD: ROLL
INSULATION: R11 KRAFT
JOISTS: 2x8 @ 16" O.C. (#3 SYP)
DECKING: 3/4" STURDI FLOOR T&G PLYWOOD
COVERING: 1/8 TILE
SKID: P/T LAMINATED (3 LAYER)

EXTERIOR WALLS:

STUDS: 2x4 STUD GRADE @ 16" O.C. - 8'-0" WALL HT.
BOTTOM PLATE: 2x4 SINGLE BOTTOM PLATE
TOP PLATE: 2x4 DOUBLE TOP PLATE
COVERING: 1/2" VINYL COVERED GYPSUM W/ 4" BASE
SHEATHING: 3/8" OSB
INSULATION: R11 KRAFT
SIDING: 26 Ga. PAINTED GALVANIZED STEEL (0.0217 NOM.)
TRIM: 26 Ga. PAINTED GALVANIZED STEEL (0.0217 NOM.)

INTERIOR WALLS:

STUDS: NONE
COVERING: NONE
INSULATION: NONE
CLOSETS: NONE

ROOF:

RAFTERS: 2X8 (#3) SYP 16" O.C.
CEILING JOIST: NONE
MATE BEAM: ENGINEERED GIRDER
CEILING: SUSPENDED "T" BAR
INSULATION: R-19 KRAFT FACED FIBERGLASS
SHEATHING: 1/2" CDX PLYWOOD SHEATHING
ROOFING: 26 Ga. PAINTED GALVANIZED STEEL (0.0217 NOM.)
TRIM: 26 Ga. PAINTED GALVANIZED STEEL (0.0217 NOM.)
TIE DOWN: (4) OVER THE ROOF (PER SIDE)

DOORS:

EXTERIOR DOORS: (2) 36" x 80" MD-300, 10X10 WINDOW
LEVER & KEYED LOCK/DEADBOLT & CLOSER
INTERIOR DOORS: NONE

WINDOWS:

WINDOW 1: (2) 30x42 INSULATED CLEAR GLASS, V/S, LOW "E"

ELECTRICAL:

LOAD PANEL: (1) 125-AMP W/MAIN ("A" SIDE)
(1) 125-AMP MAIN LUG ONLY ("B" SIDE)
RACEWAY: EMT (#12 WIRE MINIMUM)
LIGHTS: (9) FLUORESCENT (2) BULB 4' DROP-IN
(2) PORCH LIGHTS (PHOTOCELL)
RECEPTACLES: (7) 110-VOLT 15-AMP DUPLEX
(1) 110-VOLT 15-AMP GFI DUPLEX
MISCELLANEOUS (2) EMERGENCY/EXIT LIGHT

PLUMBING:

WATER CLOSETS: NONE
MODESTY PARTITION: NONE
URINAL: NONE
LAVATORY: NONE
WATER HEATER: NONE
SHOWER: NONE
POTABLE WATER: NONE
DWV: NONE
SEWER VENT: NONE
ACCESSORIES: NONE
MISCELLANEOUS: NONE

HVAC:

A/C - HEATING: PER ENGINEERED CALCS. (3 TON)
DUCT: FIBERGLASS
DIFFUSERS: (6) 2' x 2' 4-WAY (DROP-IN)
RETURNS: AT UNIT
EXHAUST FANS: NONE

MISC:

COFFEE BAR: NONE
MISC.: NONE

GENERAL SHELTERS OF TEXAS, INC.



Serving The Southwest
"Exclusively Through Independent Dealers"

TITLE:

SPECIFICATIONS

CUSTOMER:

PROJECT:

24 x 30 CLASSROOM

JOB NO.

070407

SHEET

SS

DATE: 7/16/07

SCALE: NONE